

300-44

300-44 (SN Acquisition, recent)

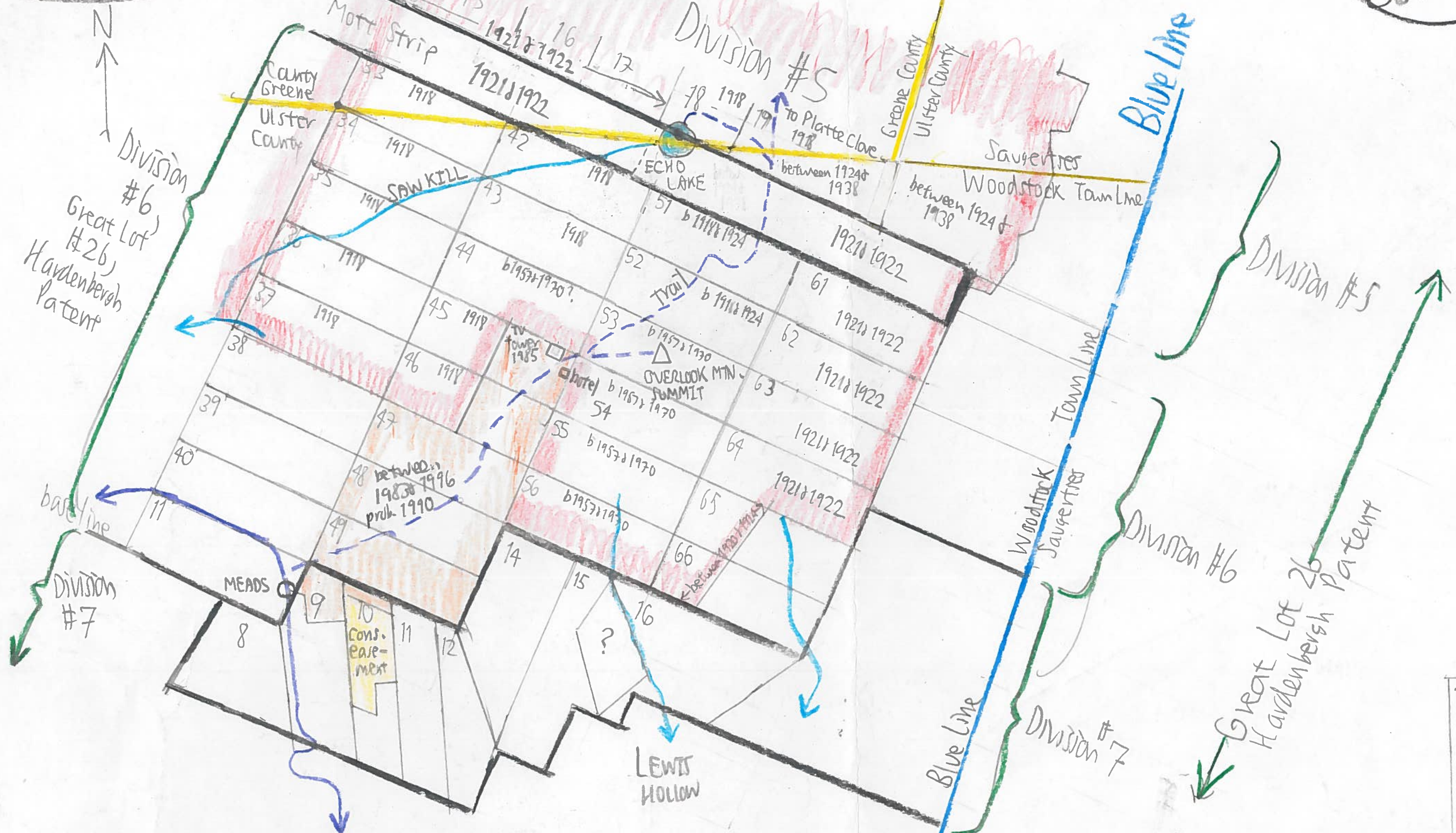

Where?
 2003- (Nixon) 285 acres via Open Space Trust to Woodstock Land Conservancy
 1990- (Profar, p.9, 1994) 312 acres with two 2-acre leases

The most recent DEC Land Map which shows the road from Meads to the hotel is 1957 (copied here). The 1970 & 1983 do not.

Two 2-acre leases, 1962 & 1984 Grand TV tower (Profar, 1998, p.9) still private?

Mike Kudish 9/6/09

Meads Mtn. Rd. to Woodstock
 Scale = 5x the 1983 Catskill Land Map
 This map: 1 mile = 62.5 mm
 1983 Map 1 mile = 12.5 mm