

Folder B 2977

"Chestnut Cove" of Pakatakan Mtn.

RYAN TRAPANI calls this "KEENEY HOL-(R₁)LOW"

10/22/09
with
Emm Karl

Site	P	Δp	Δe	e scale	e map	time	R
(A) South Side Rd. Spur	30.10	0.00	—	<u>0.926</u>	1370'	9:15 AM	$R_1 = \frac{2500' - 1370'}{30.10 - 28.88} = \frac{1130'}{1.22''}$
(B) Turn off 1st terrace	29.94	0.16	148	1518	1550'		
(C) Quarry	29.52	0.58	537	1907	1900'		
(D) 1st chestnut; ^{long level}	29.45	0.65	602	1972	1950'		
(E) Spring	29.43	0.67	620	1990	2040'		
(F) 2300' level	29.10	1.00	926	2296	2300'		
(G) Lookat	28.96	1.14	1056	2426	2440'		
(H) Begin bushwhack descent	28.88 28.86	1.22 1.04	1130 —	— (R ₂) 1.087	2500'	±11:15 lunch 11:43	$R_2 = \frac{2500' - 1370'}{29.90 - 28.86} = \frac{1130'}{1.04''} = 1.087$
(I) beneath Lookat (G)	28.95	0.95	1033	2403		12:12	
(J) terrace	29.02	0.88	957	2327			
(K) reenter trail	29.05	0.85	924	2294	2300'		
(L) Klat-Chernuts, big	29.24	0.66	717	2087		12:45	
(M) stumps, healthy B	29.22??	—	—	ca. 2000'			
(N) On old road	29.36	0.54	587	1957			
(O) old pasture	29.35	0.55	598	1968	1980		
(P) hemlock grove	29.52	0.38	413	1783			
(Q) blaze, SNK	29.56	0.34	370	1740		1:47	
(R) recent logging	29.63	0.27	293	1663			
(S) begin steep down	29.72	0.18	196	1566			
(T) stonewall	29.82	0.08	87	1457			
(U) SNK corner	29.88	0.02	22	1392			
(V) South Side Road at #1286 & 1289	29.93	-0.03	-33	1337	1380'	2:20 Shack time	
(A) South Side Rd. spur	29.90	0.00	—	—	1370'	2:51.	

Does a low R suggest increasing air pressure?

Air pressure falling fast with cold front approaching. 30.10 to 29.90 = Δ 0.20" in ± 5 1/2 hours, equivalent to an elevation change of 185 feet. Note the extraordinarily high R₂ reflecting this rapid pressure drop.

1550' 1900'

(B) to (C) Bitternut hickories are quite common from where the trail reaches the 1st ledge (ca. 1500') all the way almost up to the quarry. On October 22nd, many bitternut leaves are still and bright yellow, making the trees easy to spot. Only the oaks still have yellow-brown lvs. on.

1950' (D) White pine nearly concealed in summer (by hemlocks, too) below trail on long level.

Just above pine is an SNY corner.

1972' The 1st Chestnut, broken off with top leaning over the trail, is sprouting heavily with lvs. still green.

(E) 1990' 12" Chestnut next to the spring. BIG CHESTNUT!!

2300' (F) 2300' level terrace. Last hemlock just below.

2500' (H) End hike on 2500' flat where Oak popln. terminates. Head of small ravine down to SW. 2403'

We follow beneath ledges (I) back to under the lookout (G).

Forest no different below ledges than above them on the trail. Scattered young

Chestnut, with oak common, VACCERR & VACC ANG.

(J) Terrace below W of lookout. Chestnuts absent locally, but oak & VACCERR common. 2327'

(L) An extraordinary area on a gently sloping terrace. 2087' Chestnuts 8" x 50' (est. height) but no burs. 10" x 50' Bark split. 4" x 35' Several 3" to 4" x 30'

some smaller sprouts

Several Mtn-lavender, 10 to 15' high.

Bracken, B.B., Vacc ang., Gaultheria

(M) ca-2000'. 40 year ± stumps. When was this parcel acquired by SNY? Two healthy, smooth-barked beech, one 22" & the other 18" Highest hemlock, 6"

(N) 1957'. On old carriage/log road, on contour here. Just above are 4 large boulders in a line & on contour. 100 paces (about 267 feet) to east can be seen the edge of an open pasture.

(O) 1968'. Before open pastured pond are reached, there is an old

Foundation below the road (87 paces)
probably for a barn or farm
storage shed. Stone wall below.
4 Butternuts, 1 Butternut in
pasture, DST & CARP. NEM grave below

1286. Across is # 1289, "Fruitful Furnishings" (sawmill)?

Butternut near # 1289, prob. native
Shagbark on lawn at # 1607, prob. planted

(N) 1957 to (P) 1783 Along old road which
begins to gently, then more
moderately, descend & curve
to SW: ← → One PB.
Skid roads branch off to NW,
one might be leading up to the
spring at (E).

Notes with Ryan Trapani, CFA, 11/21/09:

Butternut at spring (E), mature & dying.
Chestnut dbhs: (N) 6.55"
(E) 11.00"
(L) SE tree 8.6" } approx.
NW tree 10.0" } 15' apart

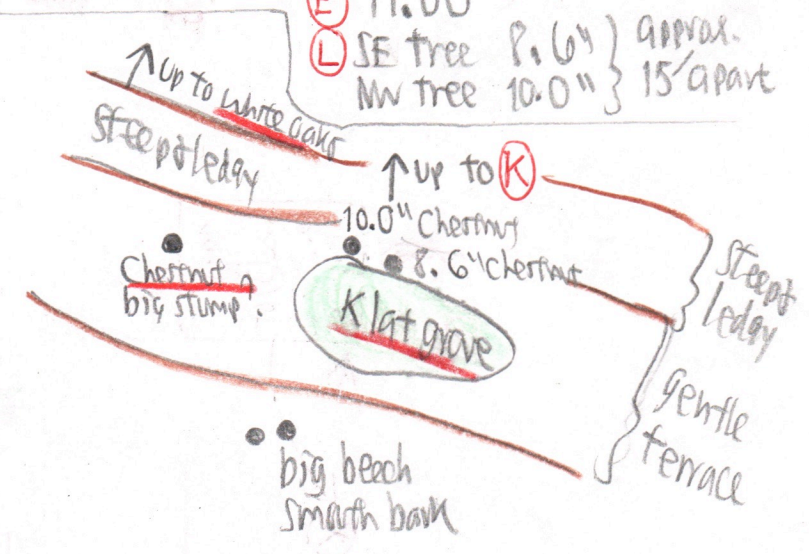

(P) 1783 Enter NEM grave on road.
Oak in canopy with NEM &
B beneath. Old road to East.

One young chestnut, below the
white oaks, has 2-ranked
twigs like an elm!!

(Q) 1740' SM blaze. Turn right &
follow it down to South Side Road,
315' tree. Posonatum?
protonemat capsules covering
a boulder. Land owner below
is Tor Roland of Greenville,
near Mansakenille, NY.

Paces: (N) to (X): 245, with a dip & bend
at 90p and a ditch at 181p.

(R) 1663' Follow blaze down through
pure NEM grave. At (R) is a Roland's
recent (5 to 10y ago) logging for
dbhs? OAK 48 to 60y old. Barbed
wire along blaze. BB

Paces: (X) to (E): Only 166, but short paces
up steeply. Maybe only 400 feet.

- (S) 1566' Follow blaze down steep ledges.
- (T) 1457' Stone wall follows blaze
- (U) 1392' SM corner. NO OAK
- (V) 1387' South Side Road. Enter at

The Crataegus on old farm at (O) are ashy-
pale smoky gray in color and look almost
like hollies. Spiraea lat, Snyg & Aumbel
dominate the field.

297-10

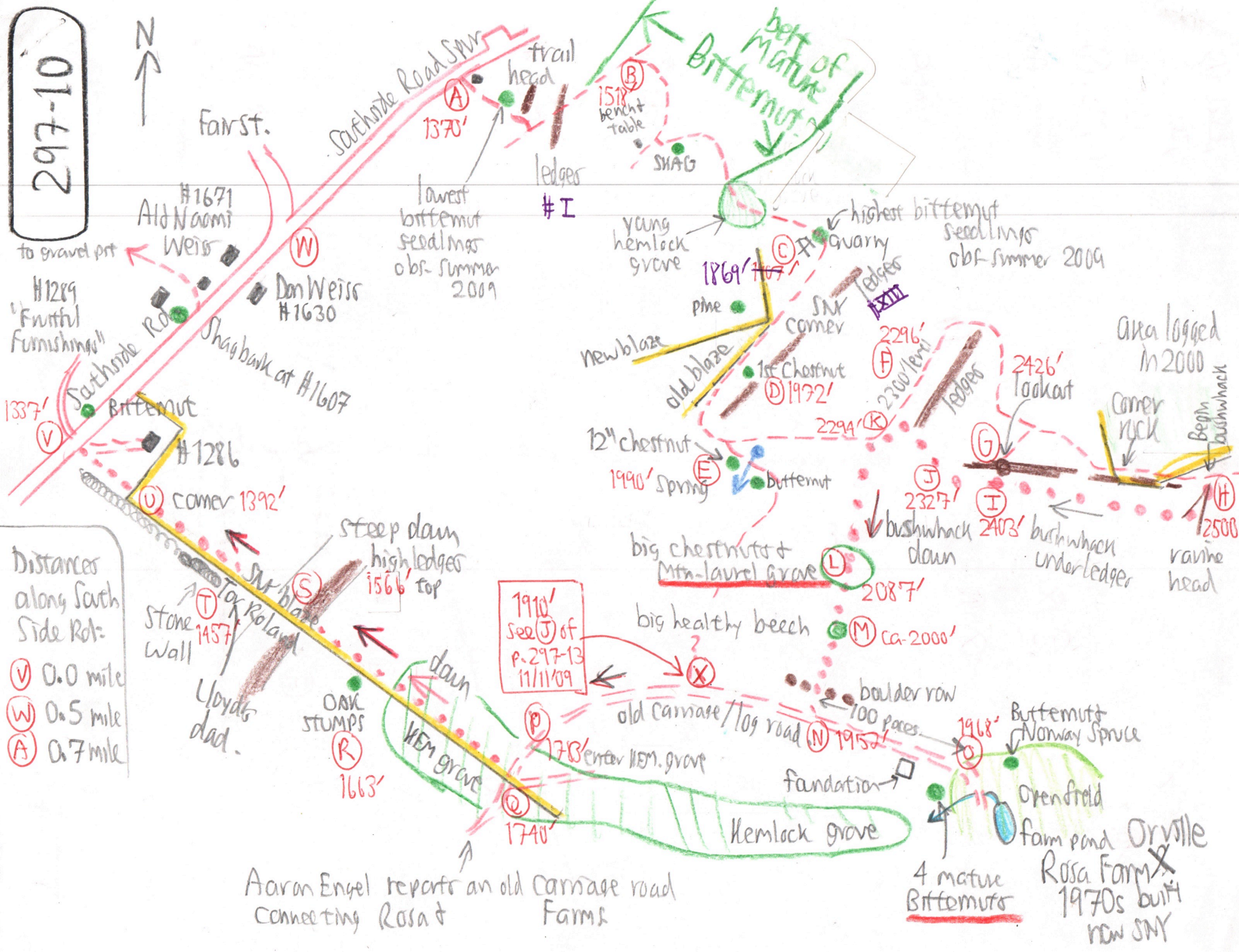

- Distances along South Side Rd:
- (V) 0.0 mile
 - (W) 0.5 mile
 - (A) 0.7 mile

1910' See J of P. 297-13 11/11/09

Aaron Engel reports an old Carriage road connecting Rosa & Farms

4 mature Bitternut
Orville Rosa Farm
1970s built now SNY