

Old Mountain Road : ascent 513-11

up Escarpment with Bob Titus 11/11/07

site	p	Δp	Δe	e calc	e map	time	R
(A) trailhead, Mtn-House Rd.	30.83	0.00			R=0.954 700'	9:59 AM	$\frac{2140' - 700'}{30.83 - 29.32} = \frac{1440'}{1.51} = \text{0.954}$
(B) stone walls	30.72	0.11	105	805			
(C) <u>Tulip tree</u>	30.62	0.21	200	900			
(D) road to NE with gate	30.60	0.23	219	919			
(E) log road to NW	30.50	0.33	315	1015			
(F) <u>SNAG</u> leadlets	30.46	0.37	353	1053			
(G) enter SNY	30.41	0.42	401	1101			
(H) overhanging ledge	30.27	0.56	534	1234			
(I) Inn site	30.22	0.61	582	1282	1270'		
(J) old hemlock ± 26"	30.13	0.70	668	1368			
(K) Cabin	30.10	0.73	696	1396			
(L) 1st red pine	30.06	0.77	735	1435			
(M) road on ledge = ^{red} shale	29.96	0.87	830	1530			
(N) Lookout - Little Pine Brch.	29.93	0.90	859	1559		11:15	
(O) Lower switchback	29.85	0.98	935	1635	1620'		
(P) Level; gneiss common	29.80	1.03	983	1683			
(Q) Upper switchback	29.74	1.09	1040	1740	1700'		
(R) Winter Cove Trail Jc.	29.63	1.20	1145	1845		11:47 AM	
(S) Swamp terrace	29.63	1.20	1145	1845			
(T) more pines, red ewh	29.60	1.23	1173	1873		NOON	
(U) Jc. Palenville O'lock	29.43	1.40	1336	2036			
(V) North Lake	29.32	1.51	1440	2140	2140'	12:23 PM	

Mileage:

2810	→ 0.0	8:30 AM ±
Palenville: 23rd + Boggart Rd	41.8	
Trailhead, Mtn-House Rd.	45.2	9:48 AM
Titus', Freehold	59.2	

Old Mantain Road: descent

513-12

site	p	Δp	Δe	e calc	e map	time	R ₂
V North Lake	29-32	1.48	1440	<u>R₂-0.973</u>	2140'	lunch 12-57	
W bog #342	29-38	1.42	1382	2082		±20 min. stop	
U Palenville O'look Jc.	29-44	1.36	1323	2023			
X 2 red spruce	29-50	1.30	1265	1965			
Y wet terrace	29-56	1.24	1207	1907			
Z trail bisect to a wet terrace	29-65	1.15	1119	1819			
W Upper Switchback	29-77	1.03	1002	1702	1700'		
O lower switchback	29-86	0.94	915	1615	1620'		
N lookout, Little Pine Ditch	29-93	0.87	847	1547			
K Cabin	30-12	0.68	662	1362			
AA 2 Shagbark	30-19	0.61	594	1294			
I Inn	30-22	0.58	564	1264	1270'	2-55 to 3-00	
E bridge & log road to ^{mw}	30-50	0.30	292	992			
D road up to NE with gate	30-64	0.16	156	856			
B road N + stone wall	30-70	0.10	97	797		3-25	
A Trailhead	30-80	0.00	—	—	700'	3-30	
add (BB) log roads up to NE & then SW down	30-55	0.25	243	943			

$$\frac{2140' - 700'}{30.80'' - 29.32''} = \frac{1440'}{1.48''} = 0.973$$

Trail mileage from signs
 0.0 mile Trail head
 3-7 mi Palenville O'look trail jc (1.7 miles to south)
 4-? mi North Lake

Ideas on balsam fir: When John & Wm. Bartram climbed the Escarpment ¹⁷⁵³ ~~ca 1749~~ to collect fir seed for ^{Peter} Collinson, they might have searched for the station in this bog, Bog #386 NE of Kaaterskill Hotel, ^{and} or the small swamp SW of the CMtn House found by Olney Bennett.

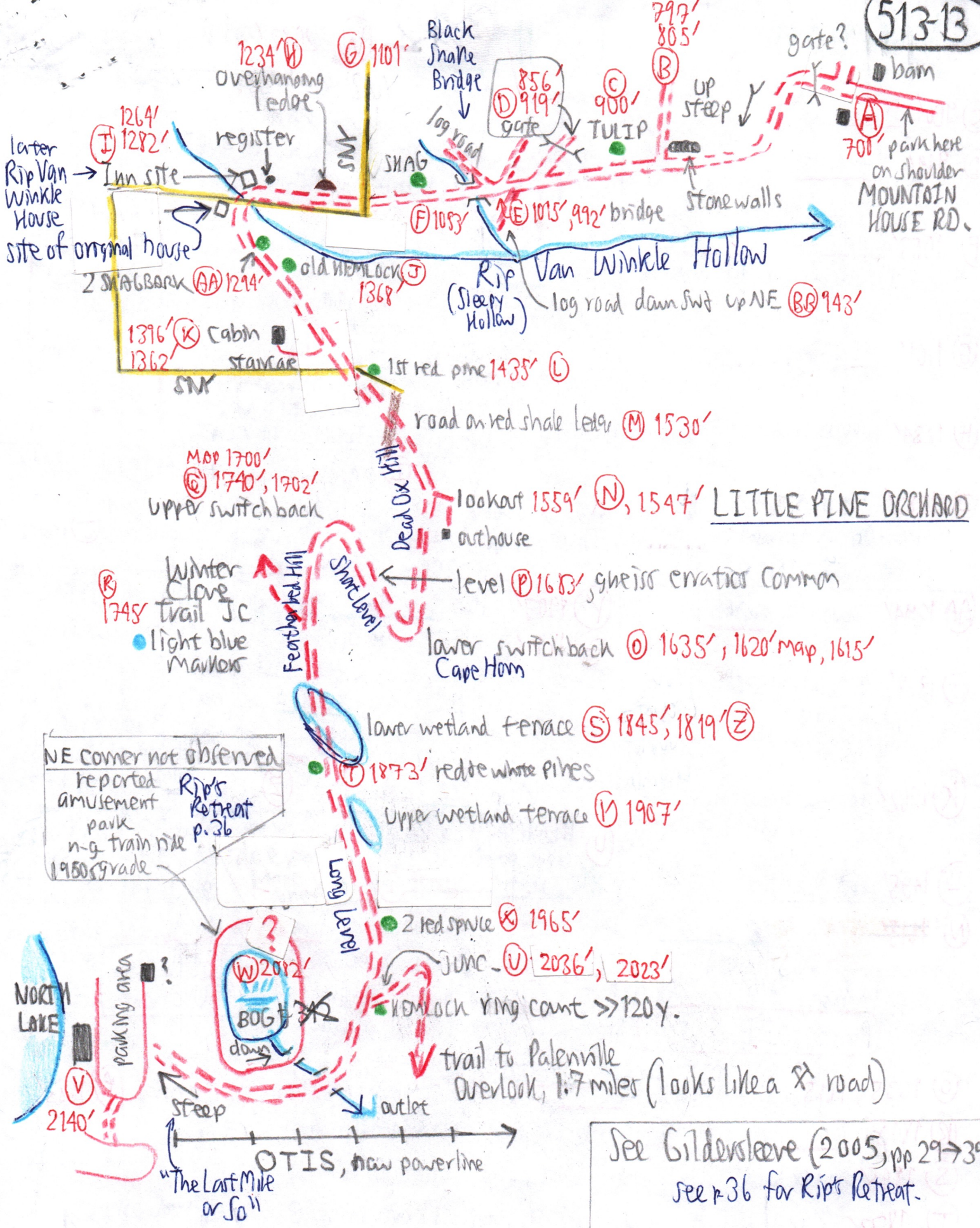

Vegetation

Boag # 406 (W) 2082' apparently has 513-14

Summed the burn & the 1950s amusement park
train ride (any photos?) which surrounded it. Boreal
forest intact. See Gildevolvee (2005 pp 29-39),
for Rip Van Winkle Village.

- | | |
|------------|--------------------|
| HFM | OX |
| SPRUCE | BAZZ |
| <u>FIR</u> | ASTER PUNCT |
| ALNUS | GLYCYBTA NERV |
| KB | CINOCLEA |
| ILEX VERT | CIMN |
| V. CASS | SPHNUM more common |
| SPIRAEOLAT | at N end. |

Many probes
nearly
engulfed
48" hiking
stick.

- (C) 900' TULIP 12"±
- (D) 919' CH OAK
- (F) 1053' SNAG leaflets, VIB ACER,
MO thicket. Stumps 20y.
- (G) 1101' KLAT, PB, CHESTNUT
- (H) 1234' SOLID FLEX, ADIV

Outlet is dom by DAK, ILEX MONT & KLAT.

- (I) 1282' BASS, ASH, SUB dom,
KB-B, HFM understory, BB,
PA-LAP, SINT

The area around (I) hasn't burned in at least 200 y.
Two healthy 20" Beech S of bridge on lower side.
Three SUGS 24 to 30". HFM ± 26" above at (J) must
be at least 200y. DAK dom above on N.

- (AA) 1294' Two 12" SNAGS
- (J) 1368' 1 OLD HFM 26"± } NO
prob. 200y. } count =
ASTER CORD } Sapling
on graph.

(Y) 1907' } Two wetland terraces, both with ILEX
(Z) 1819' } VERT. The upper is below the trail with
standing water, surrounded by KLAT & a
few young SPRUCE. Chestnut (?) 5" dead
leaning trunk at N end with 3 pcs collected.
Probably no peat. 1800' ledge beneath SS
More SPR saplings at (Z). Upper is bisected by trail.

- (K) 1362' logged below cabin
with ± 20y stumps

(U) HEMLOCK ring cant. Think broken about 33' up & fell Tree # 35
across Pville O'lock trail. Cut up. 17" diam has
120y+ height growth to 33', ± age ± 180y?

- (L) 1435' A MACRO

- (N) 1547, 1559' Red spruce sapling in vicinity of lookout; Chestnut & N red OAK dom.
Stunted to 30'. VACC ANG., SOLID BICOLOR (?)

Little Pine
Orchard

What is ^{high} ridge S60°E true across Hudson Valley?

Photos: E & SE. SNAG sapling in SE photo.

- (O) 1635, 1615' DIERVILLA SAULTIERIA PENTICULATS - KLAT. BIRCH common in till on level above (P) 1683'

- (R) 1845' SNAG lvs. Oak acorns (N red) abundant Cropon ground.

- (S) 1845' ILEX VERT dominates 2 swamp terraces

- (T) 1873' 1 red pine on west. PB grave. Above, more e-white & red pines

- (U) 2036, 2023' Two Red Spruce young. Red pine, E white pine. * HEMLOCK ring cant (see above) CHESTNUT.

- (V) Photo of flagged trees on South Mtn: pines, spruce & hemlock.