

5/11/04 290-46 DRY BROOK RIDGE PHOTOS + BOG #303 AREA

Lv. Mill Brook Rd. 8:30 AM
 Av. Bog #303 10:30 AM
 Lv. 11:30 AM
 Av. Mill Brook Rd. 1:30 PM

13.5 mi from Unit 8 to trailhead.

2 hours each way with short photo stops.

- Photos in chronological sequence =
- 1-6 Norway Spruce plantation above Mill Brook Road
 - 3 interior
 - 2 of cones pulled apart
 - 1 of exterior
 7. South summit, north side ledge & talus with YB. Looking S.
 - 8-10. Three of Bog #303, looking E across pool to NEMO-VCAST thicket. → Middle Summit
 - 10A. 11-13. Three of YB roots exposed on a felled tree S summit, 2nd ledge down to north.
 14. South Summit ice storm damage, looking NE
 - 14a. Possibly a repeat of #7 ?? on return
 15. Bog #304
 16. YB on ledge & talus of Knob 3040'.

* YB root bark does NOT peel, scale or furrow or does trunk bark. It remains tight & silvery-yellow.

Two photos taken 5/10/04 of Sawmill #190 in E Branch Nev.

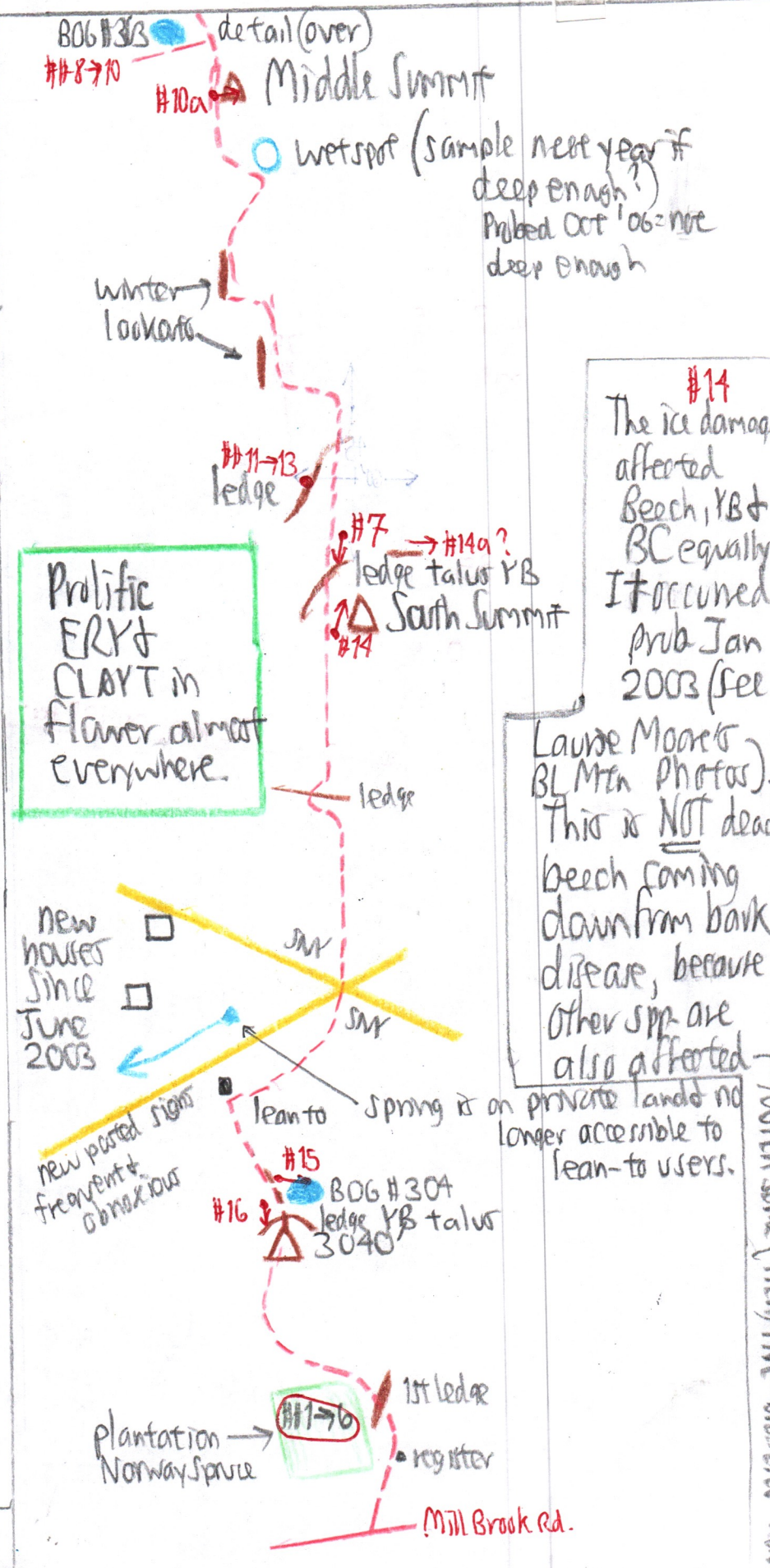

#14
 The ice damage affected Beech, YB & BC equally. It occurred prob Jan 2003 (see Louise Moore's BLM photos). This is NOT dead Beech coming down from bark disease, because other spp are also affected.

Louise Moore's BLM photos. This is NOT dead Beech coming down from bark disease, because other spp are also affected.

WITH SOME (NEW) INF. DATED NOV

29047 5/11/04
 Bog #303, diagrammatic, measured with 50-foot tape and paced.

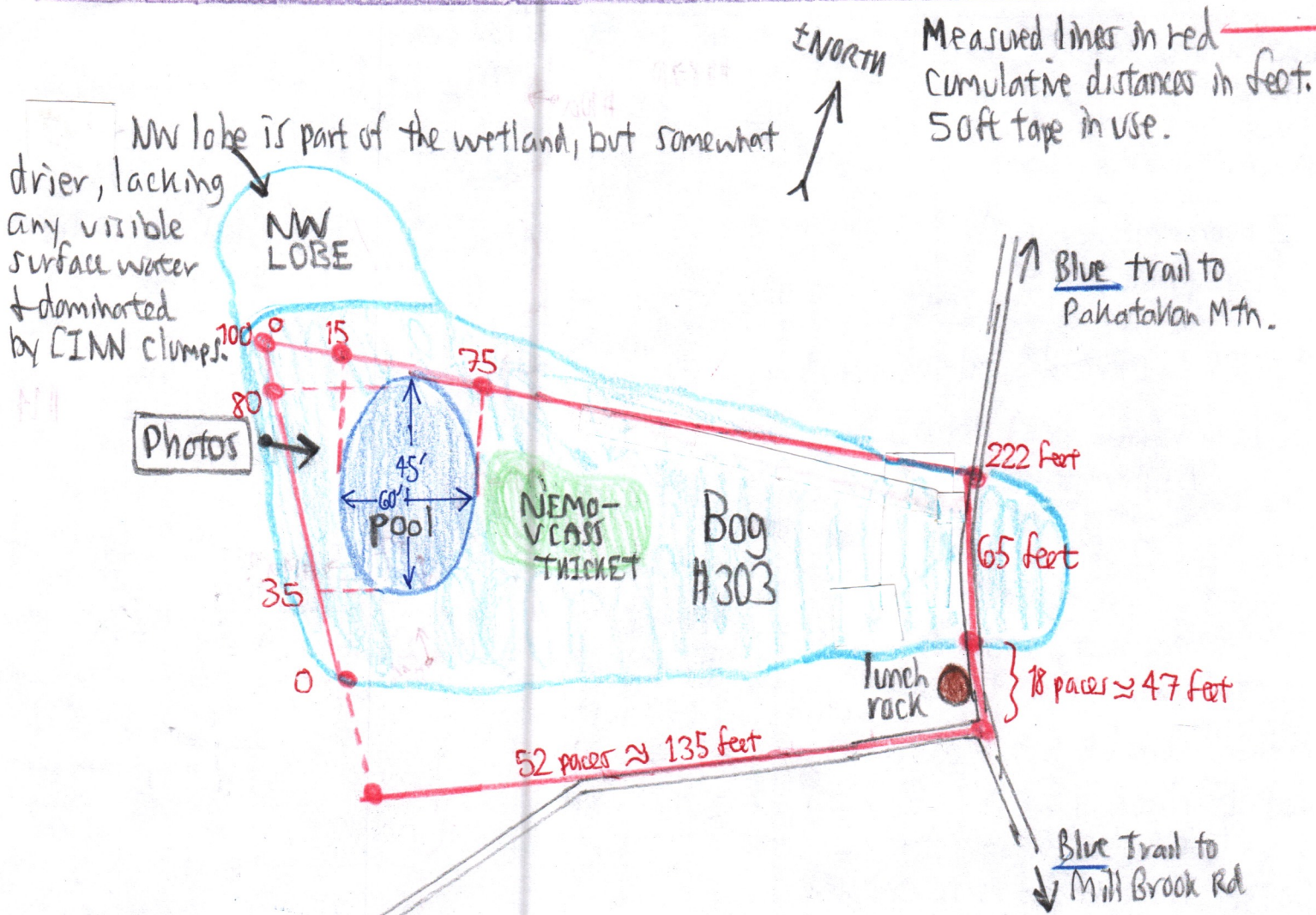

Red trail to Platz Rd
 Platz Rd - reported by hikers to be passable to vehicles

Median length: $\frac{135 + 222}{2} = 179'$
 Median width: $\frac{100 + 65}{2} = 83'$

Area: $179 \times 83 = 14857 \text{ sq ft}$
 $\frac{14857 \text{ sq ft}}{43560 \text{ sq ft/acre}} = 0.34 \text{ acre.}$

Dan Spada's estimate was 0.44 acre which probably includes the NW Lobe and the portion east of the Blue trail