

# 340-75 DEVIL'S ACRE FROM SPRUCETON

Via Devil's Path 6/12/04

Site		P	Op	De	e calc	e map	time	R
(A) Trailhead (middle)	begin	2975				2100	9:30	
	end	2975	0:00			2100	9:53	
(B) Stone wall		2964	0.11	102	2202			
(C) Red House Falls		29.53	0.22	204	2304	2320	9:48	3500'-2100'
(D) level: SUB dom; SPR repro <sup>ends</sup>		29.30	0.45	417	2517			29.75-28.24
(E) SUB dom: age tally = (U)(V)		29.14	0.61	565	2665			
(F) trail eroded & deep into till		28.80	0.95	881	2980			
(G) Fenwick RR crossing		28.70	1.05	973	3073		10:20	
(H) rill		28.62	1.13	1048	3148			$= \frac{1400'}{1.51''} =$
(I) 3 big boulders on Southwest		28.54	1.21	1122	3222			
(J) Spruce reappear with repro.		28.46	1.29	1196	3296			
(K) 1st PB, VB dom. twice		28.44	1.31	1214	3314			= 0.927
(L) 1st FIR; trail bends to E		28.40	1.35	1251	3351	Beech MO dom		
(M) Spring #1363 = measured		28.35	1.40	1298	3398			
(N) bum begins; SORB		28.22	1.53	1418	3518	Fir scattered. Spruce repro abun.		
(O) Lookout = SPR ← PB-SORB-VB		28.22	1.53	1418	3518		10:50 several fir only	
(P) trail summit in col		28-20	1.55	1437	3537			
(Q) Devil's Acre, Spring #1371	ort lean to	28.24	1.51	1400	3500	3500	11:12	
(R) Trail Jc. to Devil's Tombstone		28.23	1.52	1409	3509	3520	11:13	NO LUNCH!!
(S) turnaround on Hunter Mt. trail		27.86	1.89	1752	3852		11:57	
(T) beech enter on descent		28-04	1.71	1585	3685			
(U) Devil's Acre = Spring #1371		28.26	1.49	1400	3500	3500	12:45 to 1:13	3500-2100'
(V) Trail summit in col		28.16	1.59	1495	3595	3550		29.75-28.20
(W) Lookout		28-20	1.55	1457	3557		1:37 to 1:50	$= \frac{1400'}{1.49''} =$
(X) leave bum & sub enter		28.30	1.45	1363	3463			
(Y) Spring #		28.36	1.39	1307	3407		2:00 to 2:25	= 0.940
(Z) 3 boulders		28.56	1.19	1119	3219			
(AA) Fenwick RR crossing		28.70	1.05	987	3087		2:43 to 2:53	
(AB) Spruce saplings reenter		29.14	0.61	573	2673			
(AC) Hemr enter; levels		29.20	0.55	517	2617			
(AD) Ash		29.29	0.46	432	2532			
(AE) Red House Falls		29.53	0.22	207	2307	2320	3:33	







# Stumps above Devil's Acre:

Between (R) and (S) 340-77  
3509' 3852'

Stump#	genus	diameter	notes
1	birch	—	not burned #902
2	spruce	9" at 18" up	88y, cut to clear trail Tree#93
3	birch	—	difficult to see from trail in dense <i>Campyloptera</i>
4	conifer	6"	unburned
5	conifer	12", 3' high	broke off, not cut. unburned
Tum (S) around			Dense fir understory atop a ledge makes stump spotting difficult. Elev. 3852' at (S). Spruce+PB
6	birch	12"	Could have been to clear trail
7	conifer	12"	unburned; probably not cut.
8	conifer	12"	ditto
9	birch	10"	
10	birch	14"	stump parts more fully decomposed are like humus I.D. made at least nitted portion with hand lens
11	conifer	9"	→ unburned
(T)	birch		Upper beech limit, 3685
12	V.B	14"	Definitely PB, not PB, because of bark remnant
13	PB	20"	wavy wood vertical on outside is birch, not conifer. Non-burned. No log.
14	PB	20"	
15	PB	20"	broken, not cut

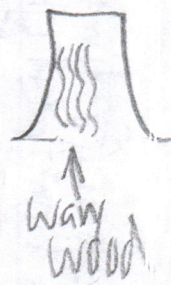

Trail Jc. ±300' E of lean-to.

Of 15 tree stumps, 9 were birch 6 spruce or fir. Most <sup>conifers were</sup> non-merchantable size and <sup>birch or conifer</sup> no charcoal. These trees <sup>may not be</sup> are ~~not~~ remnants of the Fenwick cut at all, but <sup>No more recent cut documented.</sup> much more recent. Logs fallen, because they are in the wetter humus, rot faster than the stumps; thus, most stumps only appear to have been cut because there is no log. Stumps are probably 30 to 40 (maybe 50) years but not 80 to 90. Hand lens <sup>was</sup> used to distinguish birch from conifer.



# Fenwick Grade X-ing:

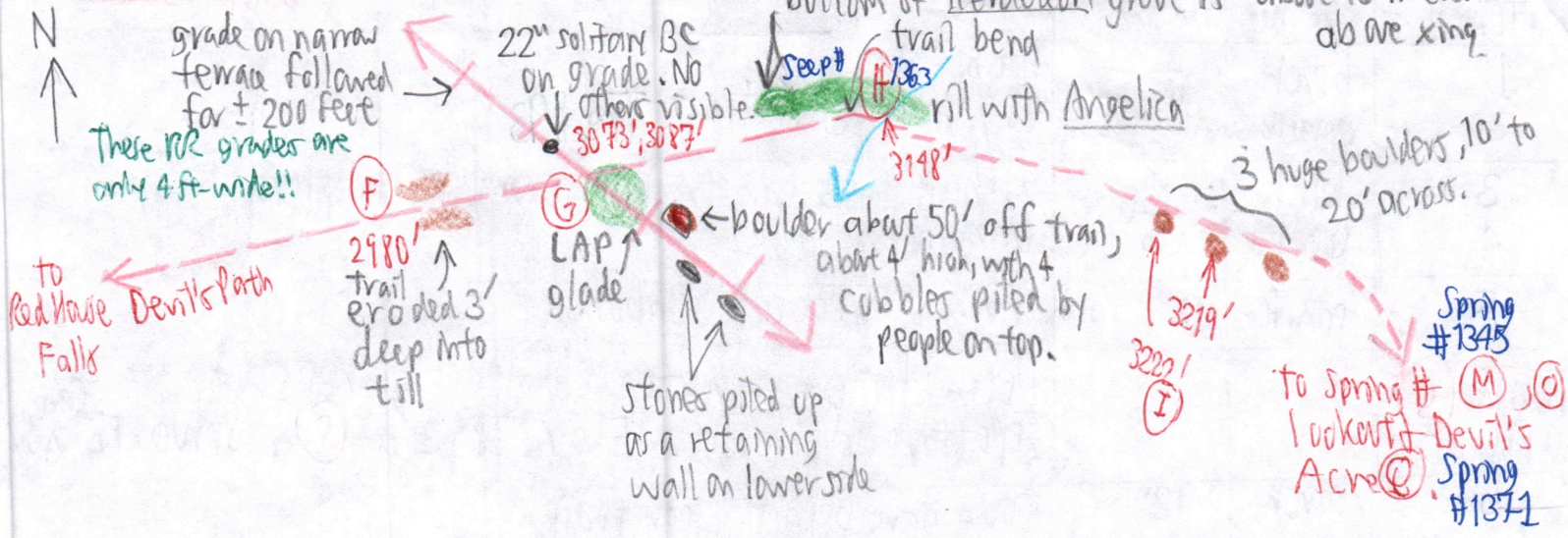

## Thoughts on spruce distn. & migration:

Spruce distn. is less a function of soil type than that of other spp.

Red spruce may not have migrated up the West Kill Valley from the west because there is NO seed source on the Halcott-Vly Range. It probably migrated in from the south, from Wittenberg, Cornell & Panther Mtns. How it skipped over the Esopus Valley is a mystery; perhaps it was burned out of the valley later.

Red spruce occurs in GROVES. One is > above 3296' at (J) and runs to summit. The 2nd is from around (A) up to (U), below 2673'. Between (J) & (U), the forest is <sup>spruceless & is</sup> dominated by SUB & LAP. Likewise, on West Kill Mtn., it grows in GROVES on the W subsummit, the 3400' W spruce, and on St. Annets Peak (see 6/7/04 notes).

Fir has a more general widespread distn. & is higher up, above 3351' here at (L). Fir grows seldom in groves.

Some tree ages: (U) BEECH 14" diam, cut 10' up: 135 to 150y Tree #C14

Tree #53 (W) SUB 21" diam, cut 10' up: 160y. Several more of similar size

Tree #54 below (M) SUB 19" diam, cut 15' up: 115y

Tree #94 → betw. (O) & (P). SPRUCE 8" diam, cut from unknown height = 62y  
Also 14" YB stump broken, with a 20-year spruce growing out of it. No log longer visible.



# More miscellaneous detail, Devil's Acre area.

% stoniness <sup>estimated</sup> in SUB-dominated slope below (J) = ±35%  
 in S-F-bunch ditto below (G) = ±30%  
 between (T) & (S) = only ±25%

Trail ended 3' deep into till at (F) 2980'

• Streptopus amplexifolius at spring (M) and at 1:21 below (P)

✓ site recorded on specimen file

Burn begins at (N) <sup>3517</sup>. Viewed from lookout (O), SW Hunter has birch bum down to ±3100 or 3200' on its north shoulder.

SUGS: Dominant at (D) with LAP glades extensive. At (E) to ±24" and up to 160y old. Not 1°, but minimally disturbed 2° because of old road (now the Devil's Path) and lumbering activity in 19th century in the area.

Ground cover other than in springs. At (K) <sup>above</sup> or <sup>TB</sup> Mc boreal cover under 1st PBs, KB dom. SUB art except in groves at springs (M) & (O).  
 CB at (N)