

Benjamin Notch to Onteora Mtn.

pronance: Efrim Abramson

520-7

5/14/01 with
Richard McIntosh, forester
&
Ephraim Abramson, owner

Site	P	Δp	Δe	e calc	e map	time	r
(A) Abramson Residence	29.47	0.00	0	2200	2200	9:00	
(B) top of open field	29.18	0.29	253	2553			
(C) oak, spruce & ash	28.90	0.57	497	2697			3220' 2200'
(D) SPRUCE FLAT, no bog	28.97	0.50	436	2636			29.47' 28.30''
Use (D) on descent: 21772 feet.							
(E) end log road -	28.46	1.01	881	3081			
(F) 1st fir	28.40	1.07	933	3133			= 1020 1170
(G) bearden ledge; breccia boulder	28.37	1.10	959	3159			= 0.872
(H) Onteora Summit	28.30	1.17	1020	3220	3220	11:30 ±	
(I) Parker Lookout on SE shoulder	28.36	1.11	968	3168			
(H) Onteora Summit	28.30	1.08	950	3220	3220	12:15 ±	
(E) end log road e.p. #12	28.42	0.96	845	3115			3220' 2270'
(DD) highest stump elev	28.47	0.91	801	3071			29.38' 28.30''
(D) level of SPRUCE FLAT on descent	28.81	0.57	502	2772			
(B) top of open field	29.12	0.26	229	2499			950' 1.080''
(J) young spruce	29.20	0.18	158	2428			
(K) young spruce	29.30	0.08	70	2340			
(L) Schooner Hollow Road	29.38	0.00	0	2270			
(M) Bog #351	29.38	0.00	220	2270	2270	2:00 ±	= 0.880
(A) Abramson Residence	29.40				2200	3:30 ±	

Summit Flora 3220'

(H) SPR to 13; 19; 21" DBH, to 40' with lightning scar
 FIR VA
 BC SM
 RM OX
 LL open & canopy groves
 Lobs CLAYT } in flower
 TB ERY }
 MO CHC
 MC

(I) Parker Lookout
 SUB within 10' of summit
 OAK, ASH, SORBS, CHC
 Breccia boulder
 piece collected
 FIR browsed seeds.

(E) 1 spruce
 B
 BC
 RM
 YB
 MO

(F) 1st fir
 scat SPR.
 SUB to 24"

(G) Bearden Ledge
 Breccia collected
 boulder on top
 FIR SPR common.
 SORBS & repro
 PIN
 Polypody crisped in drought

YB
 2PB

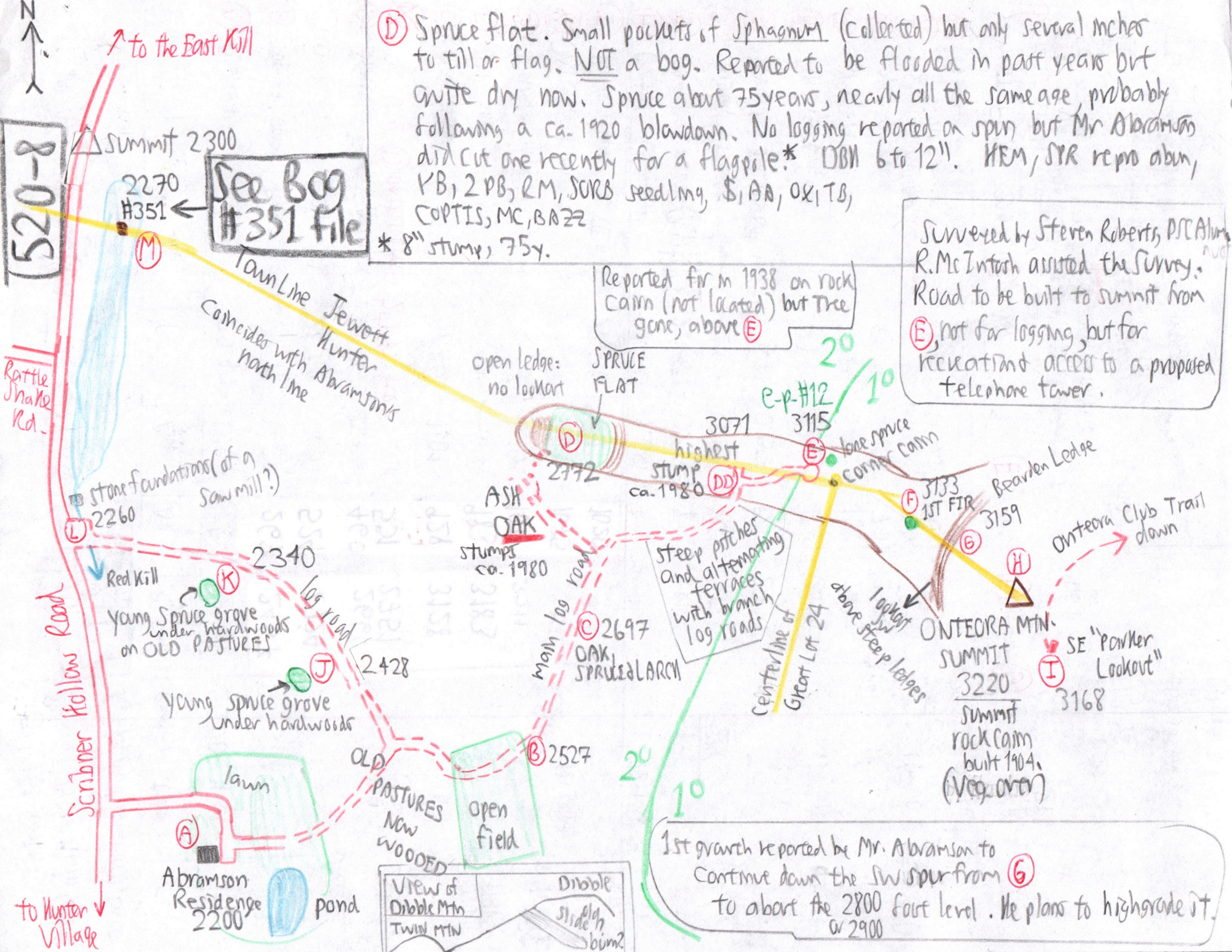

to the East Kill

520-8

Summit 2300

2270 #351

See Bog #351 file

(D) Spruce flat. Small pockets of Sphagnum (collected) but only several inches to till or flag. NOT a bog. Reported to be flooded in past years but quite dry now. Spruce about 75 years, nearly all the same age, probably following a ca. 1920 blowdown. No logging reported on spur but Mr Abramson did cut one recently for a flagpole.* DBH 6 to 12". HEM, SPR repro abun, YB, 2 PB, RM, SURB seedling, S, AA, OK, TB, COPTIS, MC, BA?? * 8" stump, 75y.

Surveyed by Steven Roberts, PSC Alum. R. McIntosh assisted the Survey. Road to be built to summit from (E), not for logging, but for recreation and access to a proposed telephone tower.

Reported fire in 1938 on rock cairn (not located) but tree gone, above (E)

Town Line Jewett Hunter
Coincides with north line

open ledge: no lookout

SPRUCE FLAT

e-p #12 20 10

3071

3115

long spruce corner cairn

(D) 2772

highest stump ca. 1980

ASH OAK stumps ca. 1980

(F) 3133 1st FIR

Bearden Ledge 3159

Onteora Club Trail down

stone foundations (of a saw mill?) 2260

Red Kill

2340

Young Spruce grove under hardwoods on OLD PASTURES

(J) 2428

Young spruce grove under hardwoods

(C) 2697 OAK, SPRUCE & LARCH

steep pitches and alternating terraces with branch log roads

Centerline of Great Lot 24

Lookout above steep ledges

ONTEORA MTN. SUMMIT 3220

(I) SE "Powker Lookout" 3168

Summit rock cairn built 1904. (Veg. over)

OLD PASTURES NOW WOODED

open field

lawn

Abramson Residence 2200 pond



1st ranch reported by Mr. Abramson to continue down the SW spur from (G) to about the 2800 foot level. He plans to highgrade it. w 2900

Rattle Snake Rd.

Scribner Hollow Road

to Hunter Village