

# Rose Mountain 401-2

with Chris Carey  
5/22/87

| Site               | Map elev.  | P     | $\Delta p$ | $\Delta e$ | e    | time               |
|--------------------|------------|-------|------------|------------|------|--------------------|
| Matyas Rd.         | (A) 1320'  | 30.66 | .00        | 0          | 1320 | 9:45               |
|                    | (B)        | .64   | .02        | 21         | 1341 |                    |
| State gate         | (C)        | .62   | .04        | 42         | 1362 |                    |
|                    | (D)        | .60   | .06        | 63         | 1383 |                    |
|                    | (E)        | .48   | .18        | 189        | 1509 |                    |
|                    | (F)        | .32   | .34        | 357        | 1677 |                    |
| Stone wall gate    | (G)        | 30.25 | .41        | 431        | 1751 |                    |
| Burroughs Memorial | (H) 2160'  | 29.86 | .80        | 840        | 2160 | 10:40              |
|                    | (I)        | .73   | .13        | 117        | 2277 |                    |
|                    | (J)        | .70   | .16        | 144        | 2304 |                    |
| End Spruce plant   | (K)        | .66   | .20        | 181        | 2341 |                    |
|                    | (L)        | .65   | .21        | 190        | 2350 |                    |
|                    | (M)        | .55   | .31        | 280        | 2440 |                    |
|                    | (N)        | .40   | .46        | 415        | 2575 |                    |
|                    | (O)        | .30   | .56        | 506        | 2666 |                    |
|                    | (P)        | .23   | .63        | 569        | 2729 |                    |
| COL                | (Q) 2740'  | .20   | .66        | 596        | 2756 | 11:25              |
| Look out           | (R)        | .17   | .69        | 623        | 2783 | lunch to noon      |
|                    | (S)        | 29.04 | .82        | 740        | 2900 |                    |
| Rose Summit        | (S) 3090'  | 28.83 | 1.03       | 930        | 3090 | ca. 12:15 to 12:30 |
|                    | (T)        | .84   | .95        | 921        | 3081 |                    |
| Look out           | (U)        | .85   | .94        | 911        | 3071 |                    |
| COL                | (R)        | 29.02 | .77        | 746        | 2906 |                    |
| COL                | (BB) 2740' | .06   | .73        | 707        | 2867 |                    |
|                    | (Q)        | .17   | .62        | 601        | 2761 | 12:57              |
|                    | (V)        | .32   | .47        | 455        | 2615 |                    |
|                    | (W)        | .36   | .43        | 417        | 2577 |                    |
|                    | (X)        | .40   | .39        | 378        | 2538 |                    |
|                    | (Y)        | .53   | .26        | 252        | 2412 |                    |
| End spruce plant.  | (L')       | .59   | .20        | 194        | 2354 |                    |
| Burroughs Memorial | (H) 2160'  | 29.77 | .0         | 0          | 2160 | 1:30               |
|                    | (Z)        | 30.00 | .61        | 625        | 1945 |                    |
|                    | (AA)       | .12   | .49        | 502        | 1822 |                    |
| Stone wall gate    | (G)        | .16   | .45        | 461        | 1781 |                    |
|                    | (CC)       | .32   | .39        | 399        | 1749 |                    |
|                    | (DD)       | .36   | .25        | 256        | 1576 |                    |
|                    | (EE)       | .54   | .07        | 72         | 1392 |                    |
| State gate         | (E)        | .56   | 0.05       | 51         | 1371 |                    |
| Matyas Rd.         | (A) 1320'  | 30.61 | 0          | 0          | 1320 | 2:17               |

rates

$$30.66 - 29.86 = 0.80''$$

$$2160 - 1320' = 840'$$

$$\frac{840}{800} = \underline{1.050} !!$$

$$29.86 - 28.83 = 1.03''$$

$$3090 - 2160 = 930'$$

$$\frac{930}{1030} = \underline{0.903}$$

$$29.79 - 28.83 = 0.96''$$

$$3090 - 2160 = 930'$$

$$\frac{930}{960} = \underline{0.969}$$

$$30.61 - 29.79 = 0.82''$$

$$2160 - 1320' = 840''$$

$$\frac{840}{820} = \underline{1.024}$$

401-3

Rose Mtn. Summit 3090'

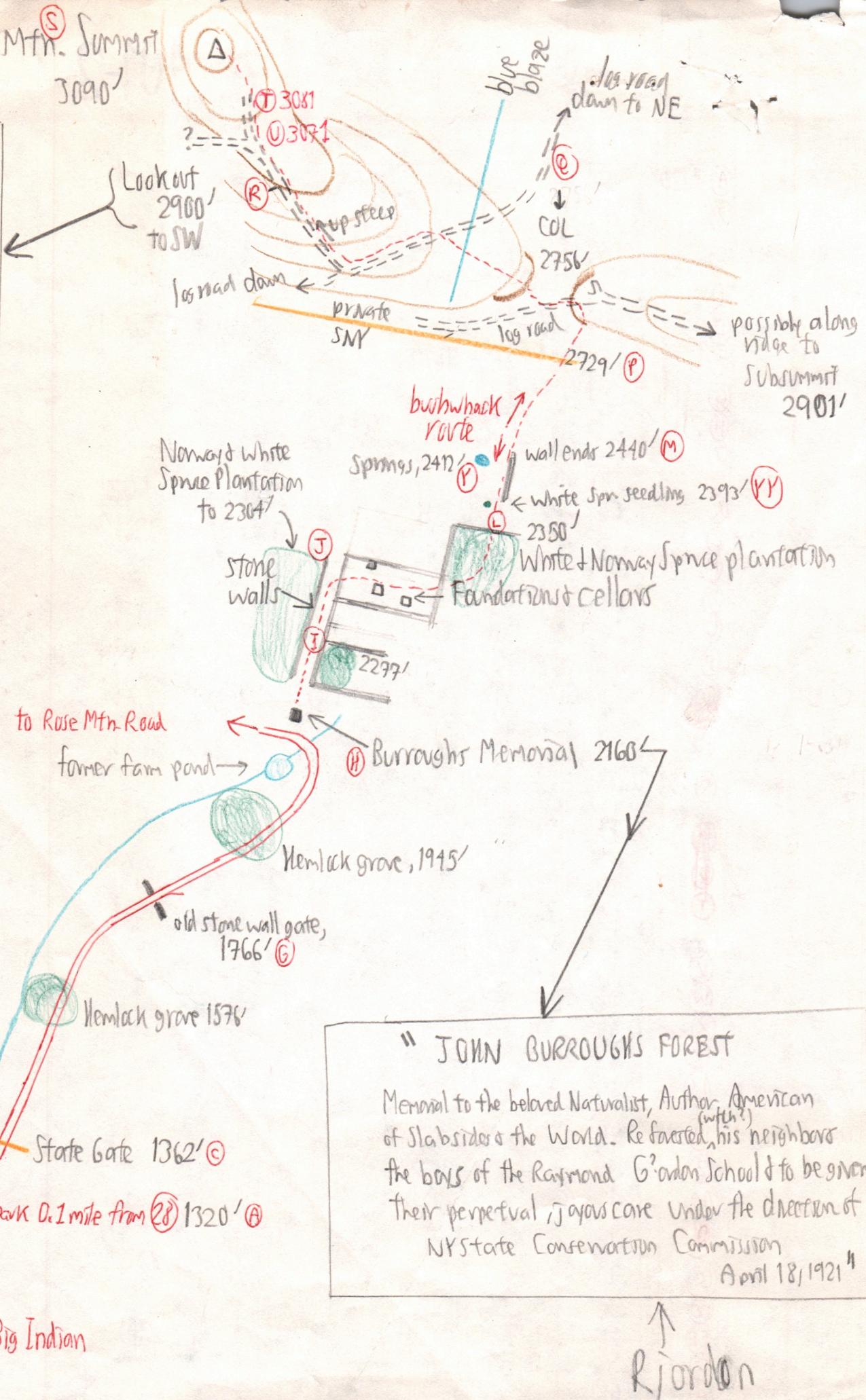
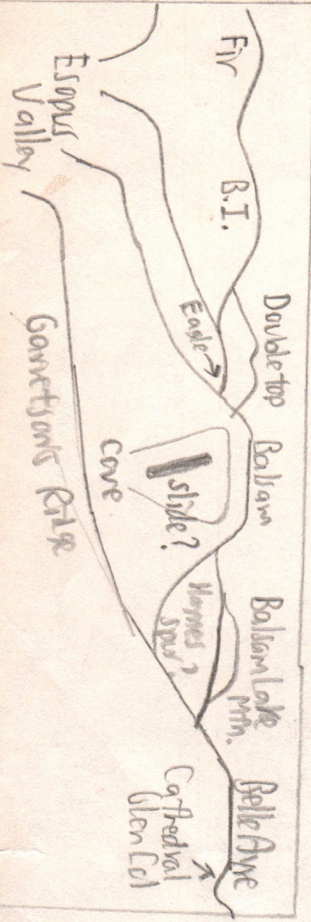

" JOHN BURROUGHS FOREST  
 Memorial to the beloved Naturalist, Author, American  
 of Slabside & the World. Re forested (with his neighbors)  
 the boys of the Raymond Gordon School to be given  
 their perpetual joy & care under the direction of  
 NYS State Conservation Commission  
 April 18, 1921 "

R Jordan

# Maximum Elevations: Rose Mtn. 401-4

## Trees

BC } to summit  
 SUB }  
 B }  
 MO }  
 YB } 3090'

> 2783 (Q)  
 ASH 2575' (N)

OST 2350' (L), 2577' (W)

BASS 2575' (N), 2538' (K)

OAK 3081' (T); abun below 3072' (U)

CARP 1822' (AA)

BIGTOOTH { 2341' (W) 6' DBH  
 2666' (O)

APPLE 2140'

BUTTERNUT 1383' (D), 1677' (P)

→ SHAGBARK 1392' (EF)

ELM (C) 1719 seedl.  
 (E) 1509 seedl.

HEM graves:  
 1576' (Z)  
 1945' (DD)

BB 2440' (M)  
 2341' (K)

TASP < 2341' (K)

Norway & WHITE  
 SPRUCE PLANTATIONS  
 2160' - 2354' (L)

RM 2350' (L) 2160' (H)

## Shrubs

ILEX MONT 2666' (O)  
 2900' (R)

AMEL 2900' (R)  
 2350' (L) falls on ground

HAMAM 2615' (V)

RCYNOS 2615' (V)

VIB ACER 2393' (YY)

CORNUS RAC 1320'

CNC 2900' (A)  
 3090' (R)

VA 3090' (S)  
 2756' (Q)

Viola pallens? no  
 beard & barely  
 pubescent leaves

PIN > 2783' (QQ)

SORB 2900' (R)

## Herbs

MC 2900' (R)  
 Medeola, VC, VPAP }

mildly  
 Copper &  
 glabrous lvs → MC (L) 2350'  
 RA, Lycu comp

OX 3090' (S)

IB 3090' (S)

SM 3090' (S)

Pali 3090' (S)

\$mont 3090' (S)

Clay infl 3090' (S)

Aquilegia 2867' (BB)

Ans } in spruce  
 Urtica } 2412' (Y)

Gaultheria 2393' (YY)

Cypripedium in spruce  
 acule plantation

At Monument 2160' (H)

AFF  
 ADIV  
 NYF  
 SOLID CORN

# Soils 40L-5

No ledge until almost the 2756' COL.  
Rochester Brook in ravine several tens of feet deep.

## Cakes:

24" at 2756' col

18" cake on summit

Fragmenting ledge at one point on summit without fill.

SUB-OAK to 28", BAS to 24" at 2873' (N)

SUB bole sprouts have bright red lvs.

Forest around Monument:

ASH-SUB-OAK-B-OSF-AMBL-BM

# Forest History

Pasture & stone walls to 2440' from 2160' Monument

Probably not cleared from about 1362' to 2160'.

Logged Rose Mtn to summit on private land, mostly for OAK & BC.

In col, slash persists but bark mostly gone. ∴ logged ca. 1980

At Blue Blaze, SUB to 36" }  
At Summit, " " 24" }

old, gnarled trees not taken.

Logging recently ca. 1980+  
older stump ca. 1950.

Oak stump diameter

21" = 85 yrs. Truff

14" = 75 yrs Tree

BC 16" = 75 yrs

H  
I  
the 6.

Oaks dominate to within 20' of summit, but with B & SUB repro. beneath

BC max abundant on summit  
Summit is BC-SUB-B-Mot  
a few KB in half leaf